



ALUMERO GROUP

YOUR BIG ADVANTAGE!

- + In-house consulting and design office
- + Competent and reliable staff
- + Aluminum mounting profiles and custom-drawn special profiles
- + Professional Machining
- + Overall production, up to the complete assembly from a single source
- + Mounting systems for outdoor and rooftop application
- + Clamp techniques, laminate and module clamp solutions
- + Customized solutions - from design to fabrication and implementation
- + Short response times, fast and flexible processing times
- + On schedule and flexible delivery and logistics concepts



ALUMERO offers for the layout of the mounting system AS2.1 the software Solar.Pro.Tool. The program includes a project report with the structural calculation and material list of the system.

You can benefit from ALUMERO's professional and comprehensive consulting service for any further questions. Our experienced engineers and technicians would be glad to be of assistance.



www.alu.pl

laminate clamps

artikel-nr: 13908
product-nr: 800311

Laminate middle clamp SECURITAS 6.8
L=70mm
for First Solar modules (6.8), Calyxo modules (6.9) and for modules with thickness from 6.8 - 6.9 mm
1592/1

drawing number: 800311 A
surface: mill finish

material: EN AW 6063 / T66; EPDM
weight: 0,068 kg/Stk
packaging: 210 Stk.



artikel-nr: 13909
product-nr: 800312

Laminate end clamp SECURITAS 6.8
L=70mm
for First Solar modules (6.8), Calyxo modules (6.9) and for modules with thickness from 6.8 - 6.9 mm
1592/1

drawing number: 800312 A
surface: mill finish

material: EN AW 6063 / T66; EPDM
weight: 0,038 kg/Stk
packaging: 470 Stk.

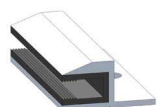

artikel-nr: 14322
product-nr: 800323

Laminate middle clamp CLICK 6.8
L=100mm
for First Solar modules (6.8), Calyxo modules (6.9) and for modules with thickness from 6.8 - 8.0 mm
1437/1

drawing number: 800323 A
surface: mill finish

material: EN AW 6063 / T66; EPDM
weight: 0,107 kg/Stk
packaging: 120 Stk.



artikel-nr: 14632
product-nr: 800323

Laminate middle clamp CLICK 6.8
L=80mm
for First Solar modules (6.8), Calyxo modules (6.9) and for modules with thickness from 6.8 - 8.0 mm
1437/2

drawing number: 800323 A
surface: mill finish

material: EN AW 6063 / T66; EPDM
weight: 0,086 kg/Stk
packaging: 140 Stk.



laminate clamps

artikel-nr: 15096
product-nr: 800323

Laminate middle clamp CLICK 6.8
L=200mm
for modules with thickness from 6.8 - 8.0 mm
1437/3

drawing number: 800323 A
surface: mill finish

material: EN AW 6063 / T66; EPDM
weight: 0,216 kg/Stk
packaging: 60 Stk.



artikel-nr: 15296
product-nr: 800323

Laminate middle clamp CLICK 5.0
L=100mm
for modules with thickness from 5.0 - 6.2 mm
1643/1

drawing number: 800323
surface: mill finish

material: EN AW 6063 / T66; EPDM
weight: 0,113 kg/Stk
packaging: 120 Stk.



artikel-nr: 15465
product-nr: 800323

Laminat middle clamp CLICK 6.8
L=120mm
for Solibro/Hanergy module SL2 and for modules with thickness from 6.8 - 8.0 mm
1437/5

drawing number: 800323 A
surface: mill finish

material: EN AW 6063 / T66; EPDM
weight: 0,129 kg/Stk
packaging: 100 Stk.



artikel-nr: 16923
product-nr: 800323

Laminate middle clamp CLICK SHARP
L=200mm
for Sharp modules
1437/3, 1896

drawing number: 800323 B
surface: mill finish

material: EN AW 6063 / T66; EPDM
weight: 0,218 kg/Stk
packaging: 60 Stk.



laminate clamps

artikel-nr: 17200
product-nr: 800323

Laminate middle clamp CLICK 3.0
L=100mm
for modules with thickness from 3.0 - 4.2 mm
1916

drawing number: 800323 A
surface: mill finish

material: EN AW 6063 / T66; EPDM
weight: 0,107 kg/Stk
packaging: 120 Stk.



artikel-nr: 17459
product-nr: 800323

Laminate middle clamp CLICK Hanwha Q CELLS
L=100mm
for Hanwha Q CELLS modules
G-10288

drawing number: 800323
surface: mill finish

material: EN AW 6063 / T66; Silikon
weight: 0,107 kg/Stk
packaging: 120 Stk.



artikel-nr: 17463
product-nr: 800323

Laminate middle clamps CLICK
further lengths, surfaces, laminate-heights as well as
individual pre-mounted sets incl. screws and nuts
or pre-packed units on request

drawing number: 800323
material: EN AW 6063 / T66; EPDM/Silikon

weight:
packaging:

artikel-nr: 14323
product-nr: 800324

Laminate end clamp CLICK 6.8
L=100mm
for First Solar modules (6.8), Calyxo modules (6.9) and for modules with thickness from 6.8 - 8.0 mm
1437/1

drawing number: 800324 A
surface: mill finish

material: EN AW 6063 / T66; EPDM
weight: 0,084 kg/Stk
packaging: 180 Stk.



laminate clamps

artikel-nr: 14633
product-nr: 800324

Laminate end clamp CLICK 6.8
L=80mm
for First Solar modules (6.8) and for modules with thickness from 6.8 - 8.0 mm
1437/2

drawing number: 800324 A
surface: mill finish
material: EN AW 6063 / T66; EPDM
weight: 0,067 kg/Stk
packaging: 220 Stk.



artikel-nr: 15097
product-nr: 800324

Laminate end clamp CLICK 6.8
L=200mm
for modules with thickness from 6.8 - 8.0 mm
1437/3

drawing number: 800324 A
surface: mill finish
material: EN AW 6063 / T66; EPDM
weight: 0,169 kg/Stk
packaging: 90 Stk.



artikel-nr: 15297
product-nr: 800324

Laminate end clamp CLICK 5.0
L=100mm
for modules with thickness from 5.0 - 6.2 mm
1643/1

drawing number: 800324
surface: mill finish
material: EN AW 6063 / T66; EPDM
weight: 0,090 kg/Stk
packaging: 180 Stk.



artikel-nr: 15466
product-nr: 800324

Laminate end clamp CLICK 6.8
L=120mm
for Solibro/Hanergy module SL2 and for modules with thickness from 6.8 - 8.0 mm

drawing number: 800324 A
surface: mill finish
material: EN AW 6063 / T66; EPDM
weight: 0,101 kg/Stk
packaging: 150 Stk.



laminare clamps

artikel-nr: 16924
product-nr: 800324

Laminare end clamp CLICK SHARP
L=200mm
for Sharp modules
1437/3, 1896

drawing number: 800324 B
surface: mill finish

material: EN AW 6063 / T66, EPDM
weight: 0,168 kg/Stk
packaging: 90 Stk.



artikel-nr: 17201
product-nr: 800324

Laminare end clamp CLICK 3.0
L=100 mm
for modules with thickness from 3.0 - 4.2 mm
1916

drawing number: 800324 A
surface: mill finish

material: EN AW 6063 / T66; EPDM
weight: 0,084 kg/Stk
packaging: 180 Stk.



artikel-nr: 17461
product-nr: 800324

Laminare end clamp CLICK Hanwha Q CELLS
L=100mm
for Hanwha Q CELLS modules
G-10288

drawing number: 800324
surface: mill finish

material: EN AW 6063 / T66; Siliikon
weight: 0,084 kg/Stk
packaging: 180 Stk.



artikel-nr: 17464
product-nr: 800324

Laminare end clamp CLICK
further lengths, surfaces, laminare-heights as well as
individual pre-mounted sets incl. screws and nuts
or pre-packed units on request.

drawing number: 800324
material: EN AW 6063 / T66; EPDM/Siliikon

weight:
packaging:

NOTES



SEEHAM AUSTRIA

Alumero
Systematic Solutions GmbH
Sonnenweg 1-2
5164 Seeham - Österreich

SINGEN GERMANY

Alumero
Lean Extrusions GmbH & Co. KG
Carl-Benz-Str. 35
78224 Singen - Deutschland

CHORZOW POLAND

Alumero
Metal Components Sp. z., o.o
Ul. Kluczborska 29
41-508 Chorzów - Polska

HELMOND NETHERLANDS

Alumero
Finex Extrusions B.V.
Duizeldonksestraat 20
5705 CA Helmond - Nederland

SL. BISTRICA SLOVENIA

Alumero
Metal Components d.o.o.
Kolodvorska 39
2310 Sl. Bistrica - Slovenija

WWW.ALUMERO.AT

CONTACT HEADQUARTER

Alumero Systematic Solutions GmbH
Sonnenweg 1-2
5164 Seeham - Austria
T +43 6217 / 68 41-0
F +43 6217 / 68 41-41
alumero@alumero.at
www.alumero.at

I'M ALWAYS HERE
WHEN YOU NEED ME.

